



CHICAGO HUB IMPROVEMENT PROGRAM (CHIP)

Transforming Chicago's Passenger Rail Experience

All Aboard Ohio

11 January 2025

Chicago Hub Improvement Program (CHIP)



Chicago Union Station (CUS) Improvement Projects:

- **Goal:** Upgrade CUS performance and customer experience:
 - Reduce station and platform congestion
 - Add capacity and accessibility for expanded services
 - Provide cleaner air in platform areas
- **Scope:** Concourse and platform renovations/expansions, and ventilation system upgrades.
- **Partners:** FRA, Illinois DOT, Cook County, City of Chicago, Metra
- **Schedule (target):** Mail Platform summer 2028; Concourse fall 2028; Commuter platform expansions and ventilation improvements FY2026-30

Chicago Infrastructure Improvement Projects:

- **Goal:** Add/purchase infrastructure to reduce travel times and improve reliability of current service while accommodating future growth
- **Scope:** Acquire and/or build new infrastructure at several sites in the Chicago area, northwest Indiana, and southwest Michigan
- **Partners:** Host Railroads (CN, BNSF, NS, UP, CSX, Metra) plus funding partners Illinois DOT, City of Chicago, Cook County, Metra, Michigan DOT)
- **Schedule (target):** 30% Design through FY 2025, final design and construction FY2026-33



CHIP Infrastructure Components

South Branch Viaduct (Bridge Replacement)



- Built in 1914, bridge is now beyond its useful economic lifespan
- Bridge carries nearly all Amtrak south and east state supported and long distance trains, plus two Metra routes, and Norfolk Southern/BNSF freight trains
- 1200 bridge openings per year because of insufficient 10' height above water (standard is 21')
- Bridge often doesn't seat during summer; also experiences problems in winter
- CN crosses Amtrak/NS mainline just south of bridge at 21st street
- Bridge replacement marks opportunity to solve multiple operational issues

Chicago Yard Acquisition and Expansion

- 14th St. Yard beyond capacity – need storage space and expanded maintenance facilities
- Following review of STV/Jacobs yard study, Amtrak has initiated preliminary acquisition discussions with Union Pacific for Canal St. Yard
 - 55 acres
 - Access controlled by Amtrak dispatching
- Proposed two-prong plan
 - Outfit northern half as storage facilities
 - Reconfigure/cover 14th St. Yard and add covered satellite maintenance facility at southern half of Canal St.

Canal St. Yard



Niles-Glenwood Capacity Expansion

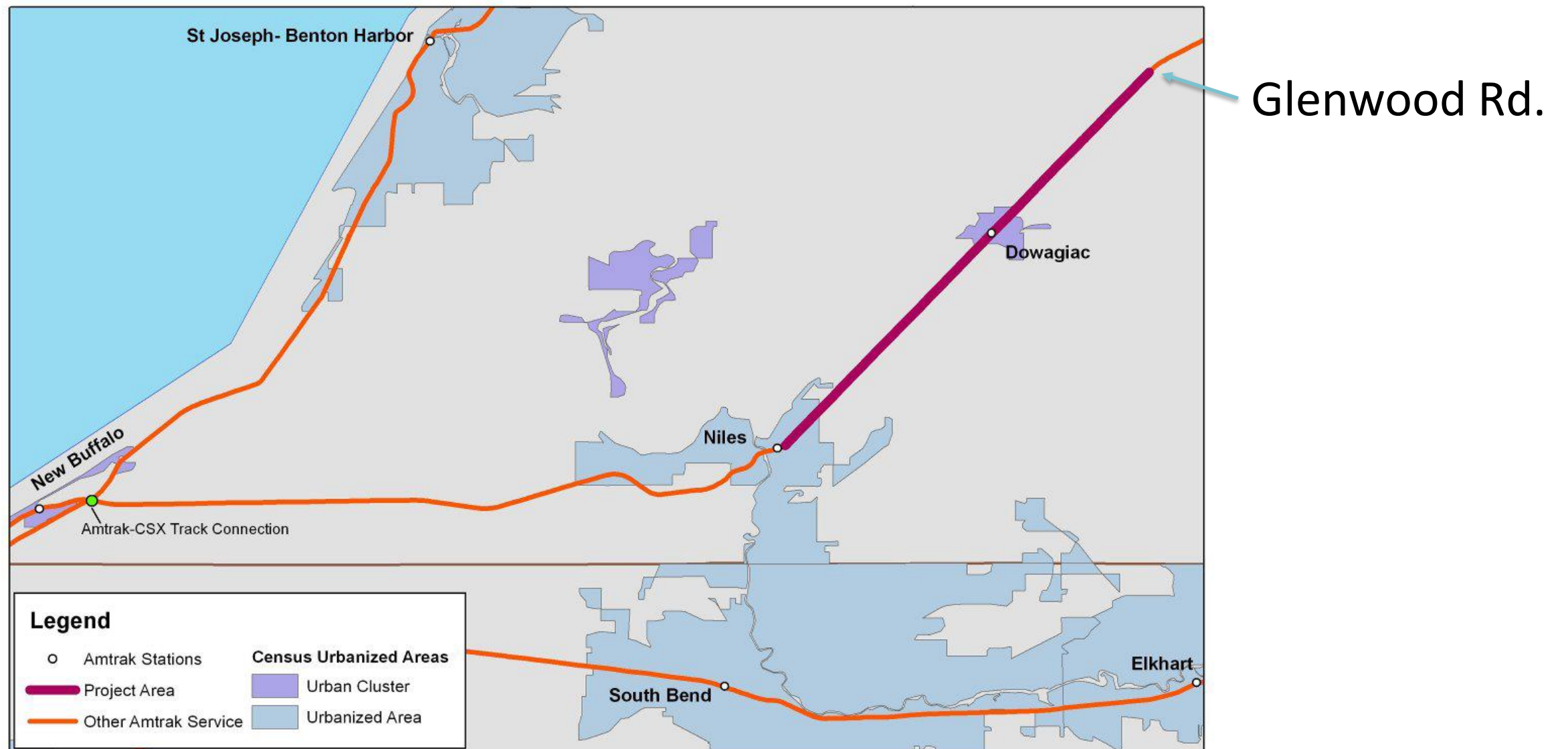

- 19-mile project area on Amtrak ownership; 16 miles now single-track
- VHB/Quandel doing PE/NEPA work
- Expect to receive NEPA categorical exclusion
- CRISI grant award received for Final Design



CHIP Chicago Union Station Components

Chicago Hub Improvement Program: Chicago Union Station Projects

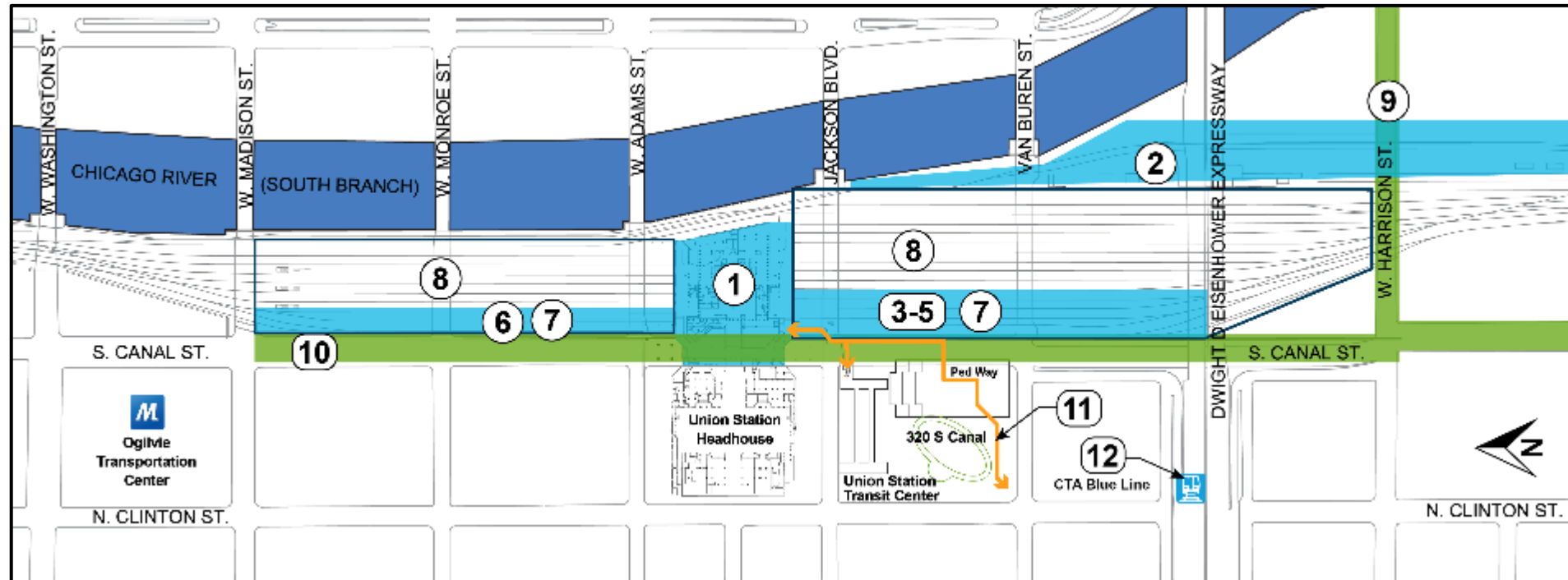

- | | |
|-------------------------------------|---|
| 1. Concourse Capacity Improvements | 9. Harrison Viaduct Replacement (by CDOT) |
| 2. Mail Platform Reactivation | 10. Canal Viaduct Replacement (by CDOT) |
| 3-6. Commuter Platforms Expansions | 11. Pedway towards CTA Clinton Station (by Developer) |
| 7. Interlocking Adjustments | 12. Clinton Station ADA Improvements (by CTA) |
| 8. Trashed Ventilation Improvements | |

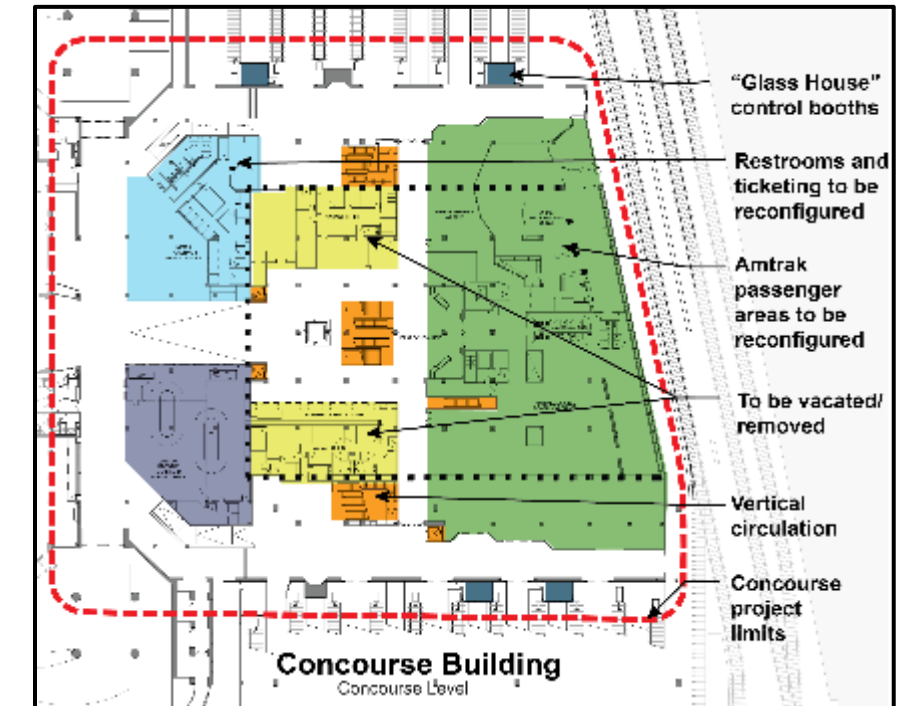

Chicago Union Station

Upgrades to the station will improve safety, increase capacity, and provide an enhanced customer experience by renovating the concourse, adding a new passenger platform, widened existing platforms, and upgrading ventilation of the train sheds.



CUS Mail Platform Reactivation for Passenger Use



Goals/Objectives:

- Reactivate the high-level mail platform for passenger use
- Create additional rail capacity and operational flexibility at CUS
- Provide the first level-boarding platform at CUS

Funding:

- PE/NEPA/FD: FRA Annual Grants
- Construction: FY22/23 FSP Grant Award
FY24 Appropriations

Schedule:

- 100% Design phase complete
- To be issued for GC bid once all egress stairwell easements executed

Real Estate easements for egress stairs (5):

- Stair B (City): Complete
- Stairs C & D (Old Post Office): In progress
- Stair E (USPS): In progress; Revised design to meet USPS requests
- Stair F (ComEd): In progress; consent letter
- Stair F (City): Complete

Delivery Method:

- Traditional design-bid-build

Consultants:

- Designer of Record: WSP / M2
- Construction Manager: HNTB
- General Contractor: TBD

CUS Mail Platform Reactivation for Passenger Use

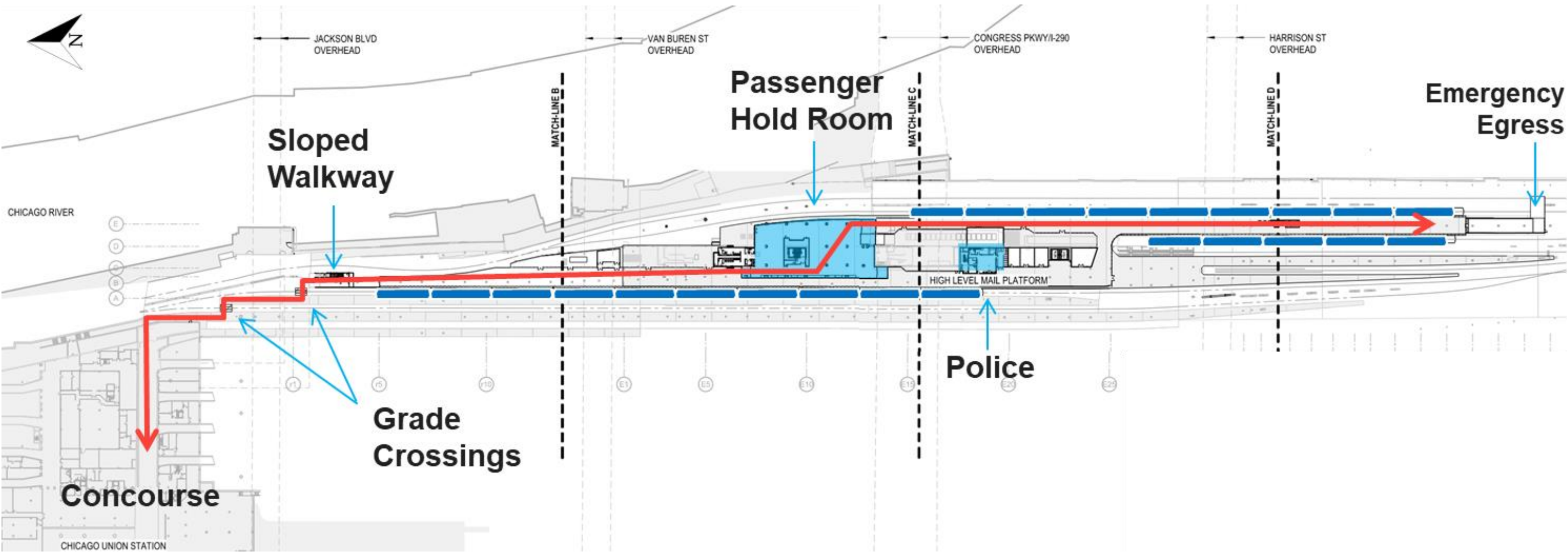

CUS Mail Platform: Emergency Egress Stairwells

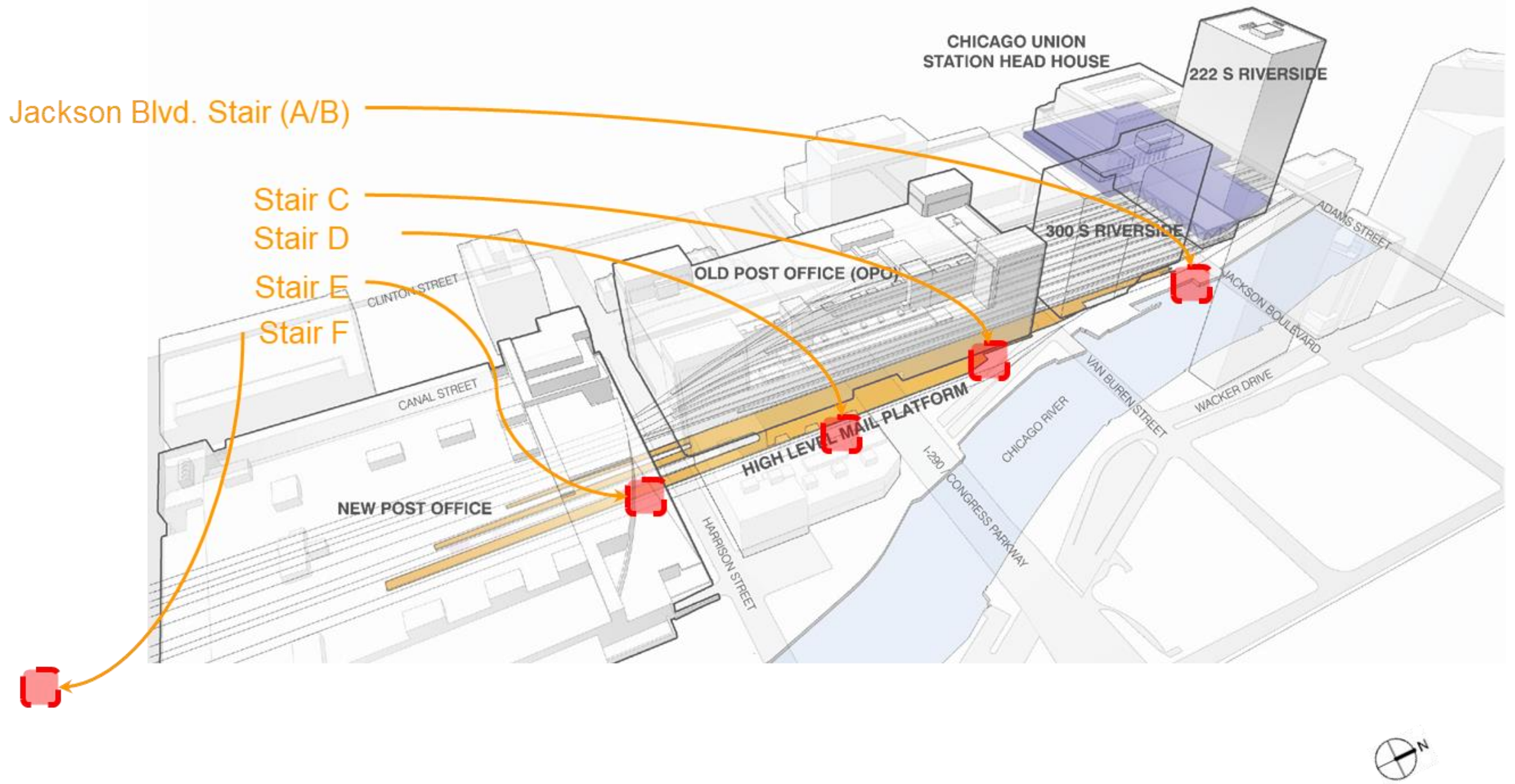

CUS Concourse Improvement Project



Goals/Objectives:

- Improve operational efficiencies, passenger flow and safety
- Welcoming and accessible space for all users
- Station fitting of a world class city

Funding:

- Preliminary Engineering/NEPA: FRA Annual Grant
- Final Design: Combination of Discretionary and Annual Grants
- Construction: TBD (will seek discretionary grant funding)

Schedule:

- PE underway
- Final Design – target start summer 2025
- Construction – target start winter 2027, 2-to-3-year duration

Delivery Method:

- Construction Manager at Risk (CMAR)

Consultants:

- Designer of Record: Epstein/FXCollaborative
- Construction Manager: TBD
- General Contractor: TBD

Concourse Improvement Project Scope

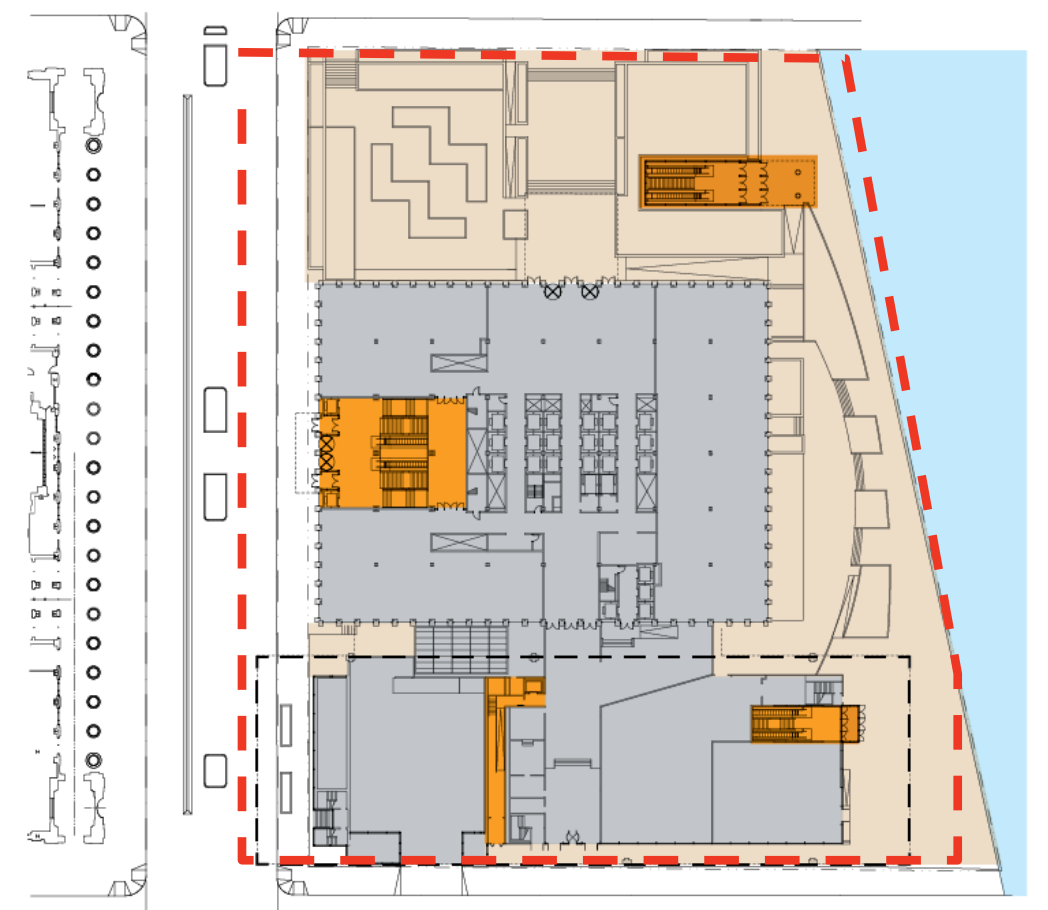
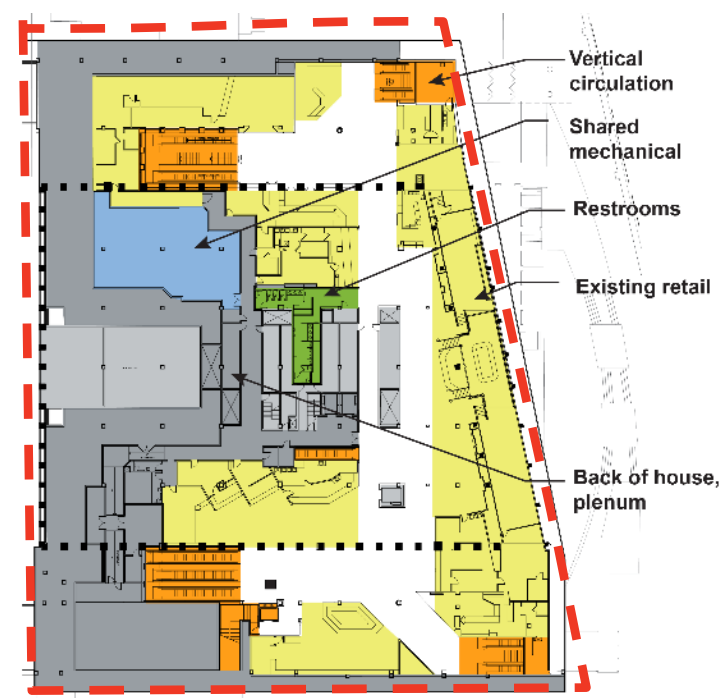
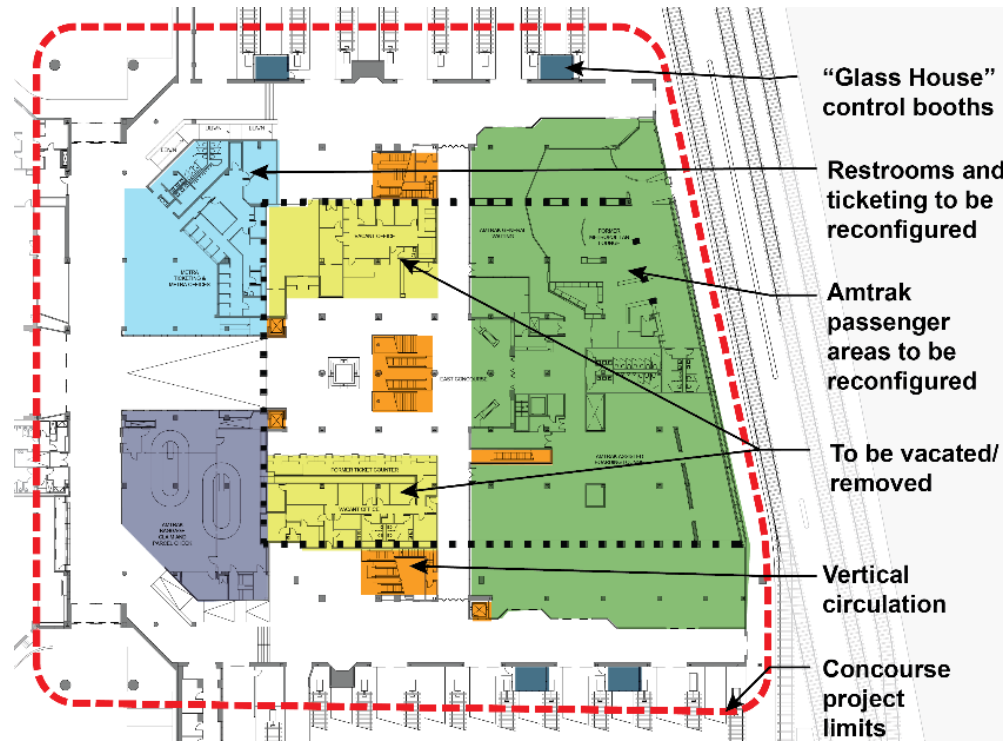

Concourse Level



Mezzanine Level

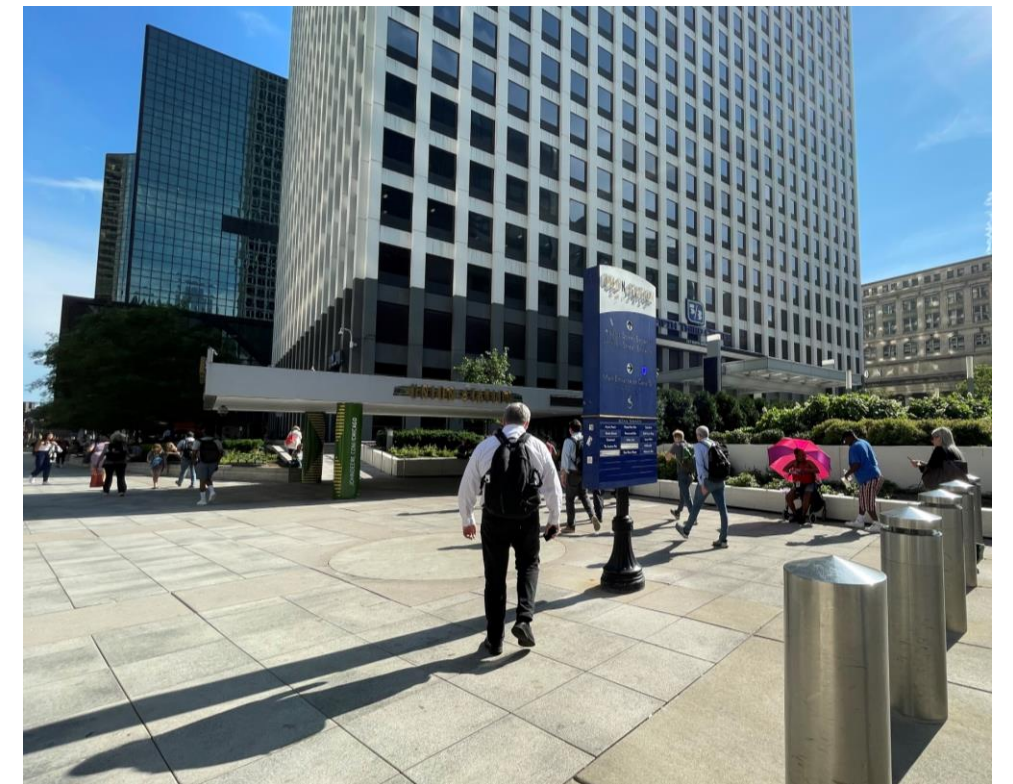

Street/Plaza

Design Character



- Renovate Chicago Union Station to be an architecturally significant transportation terminal that preserves and builds upon its architectural heritage.
- Enable passengers and visitors to use the station facilities in the most efficient, safe and pleasant manner.
- Create a vibrant transportation center and a civic hub which welcomes and serves travelers, residents, and workers alike, and enhances the economic vitality of the city and the Region.
- All of which will lead to providing a superior passenger experience at Chicago Union Station.



CUS Platform Capacity Expansions & Ventilation Improvements



Goals/Objectives:

- Widen/improve commuter platforms for improved customer safety, capacity, accessibility, connectivity and experience
- Improve the air quality within the train sheds by mitigating diesel fume exhaust
- Improve fire safety and smoke evacuation in the event of a fire in the train sheds

Funding:

- PE/NEPA: FY22/23 FSP Grant Award
- FD and Construction: TBD (will seek discretionary grant funding)

Schedule:

- Target DoR NTP spring 2025
- Full schedule under development

Delivery Method:

- TBD; Initiating analysis now
- Packaging strategy analysis completed in April.

Consultants:

- Designer of Record: TBD
- Construction Manager: TBD
- Contractor: TBD

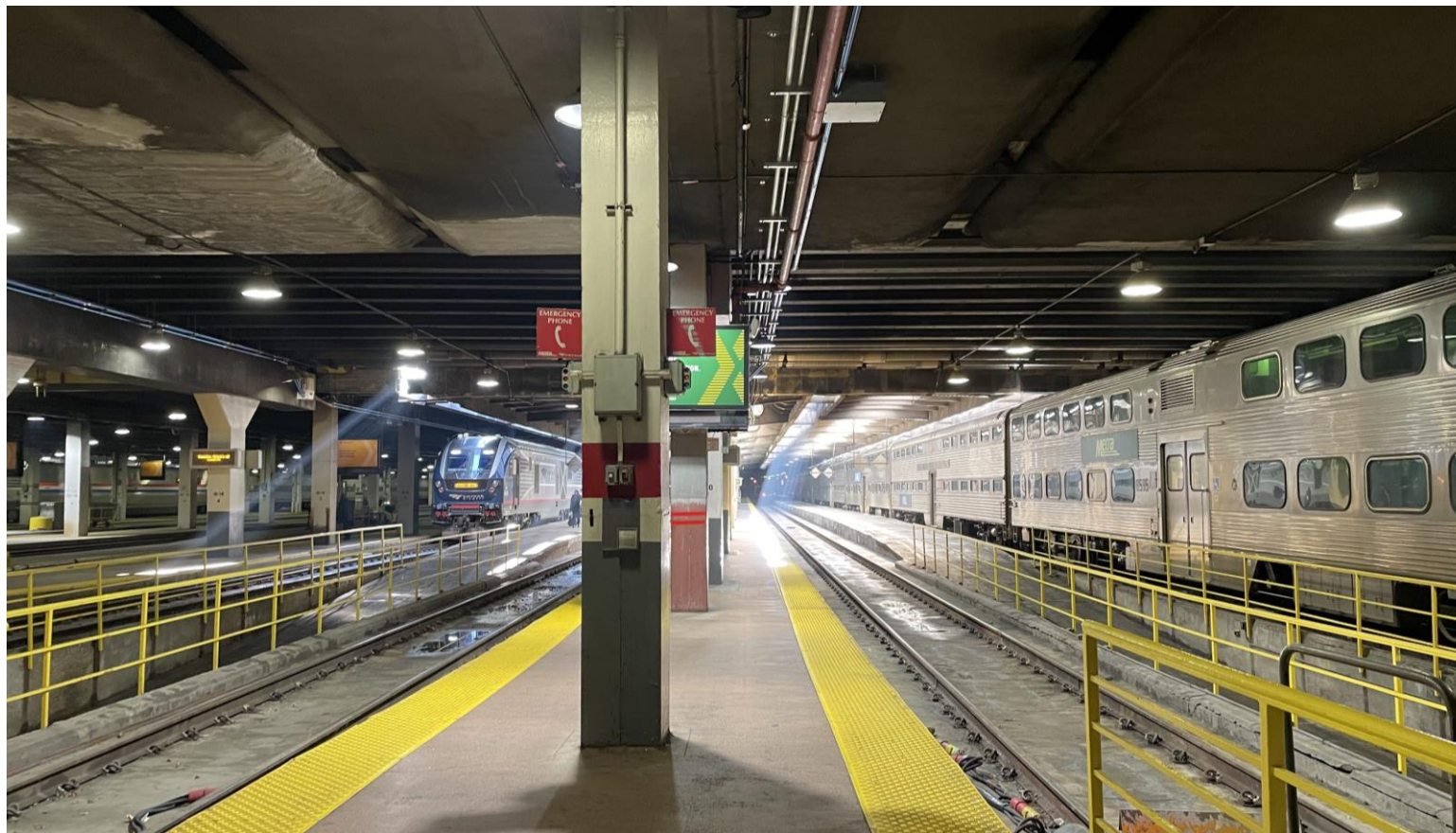

CUS Platform Capacity Expansions

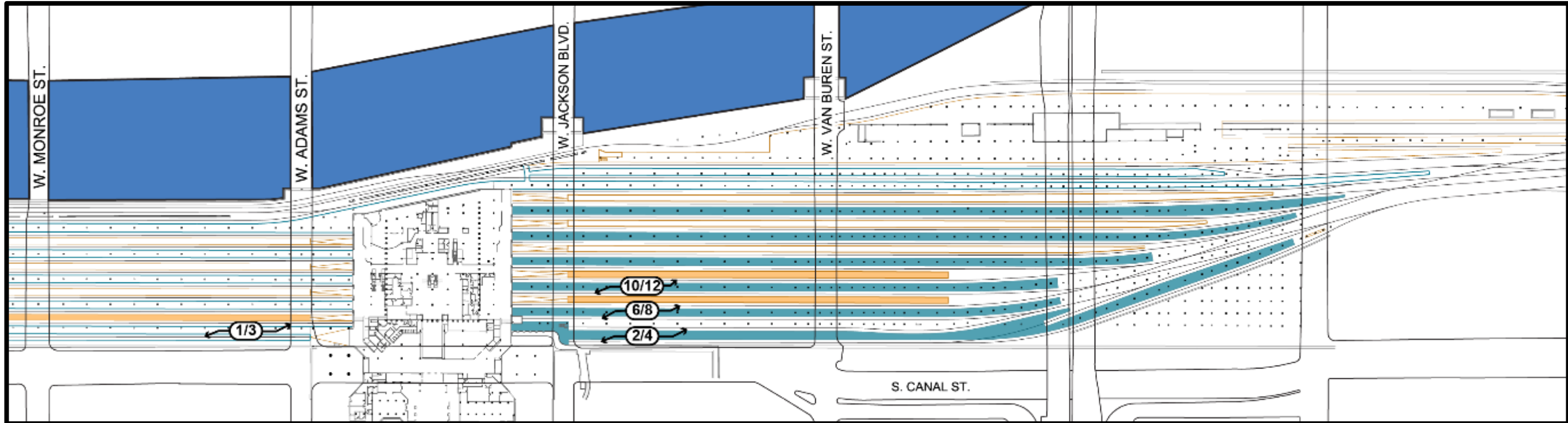

Before



After



CUS Trainshed Ventilation Solution: Air Flow Concept

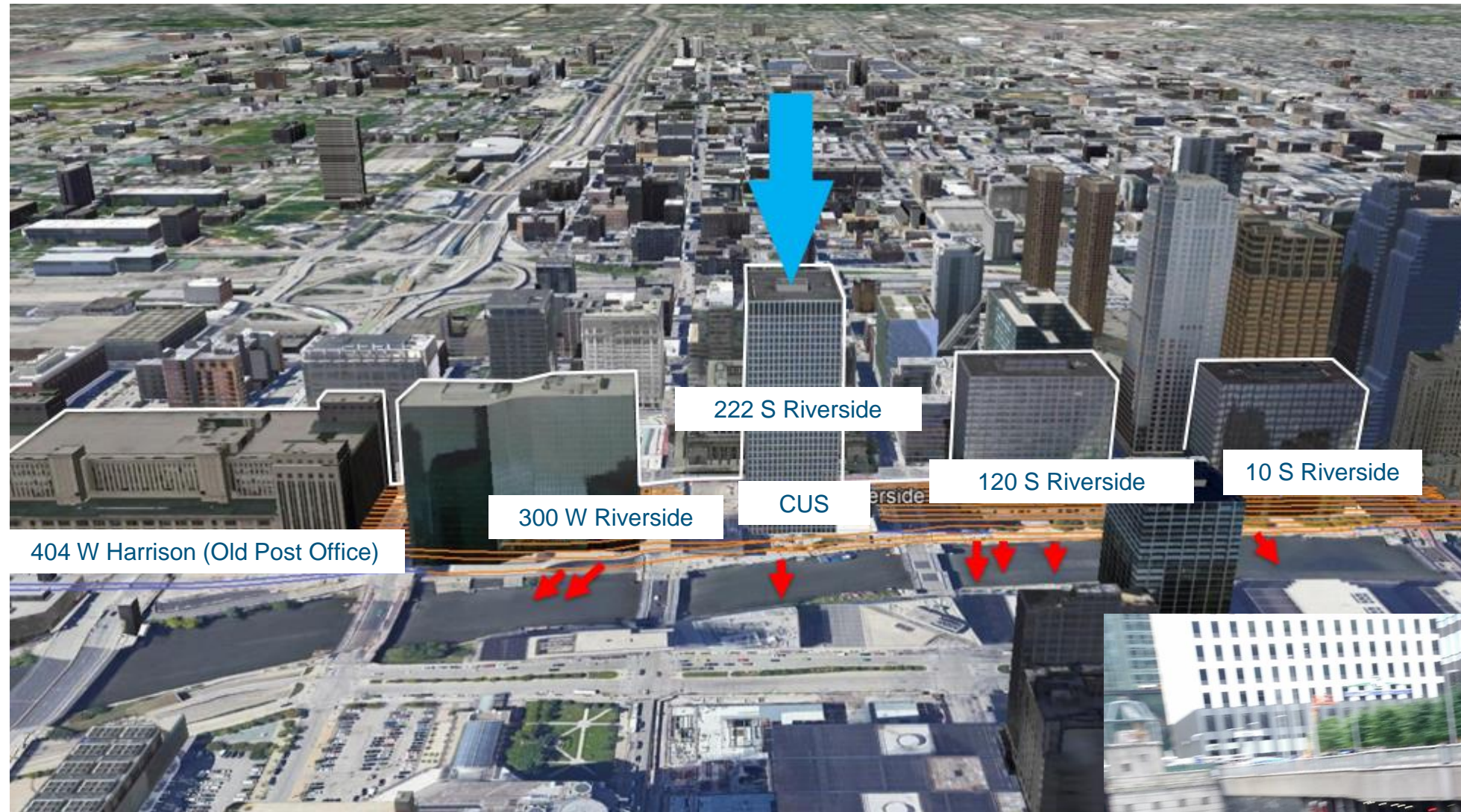



AMTRAK®